

File No. _____
 Subject to the conditions, if any, set forth in our letter dated _____
 day of _____, 201__, this draft plan is approved under
 Section 51 of the Planning Act this ____ day of _____, 201__

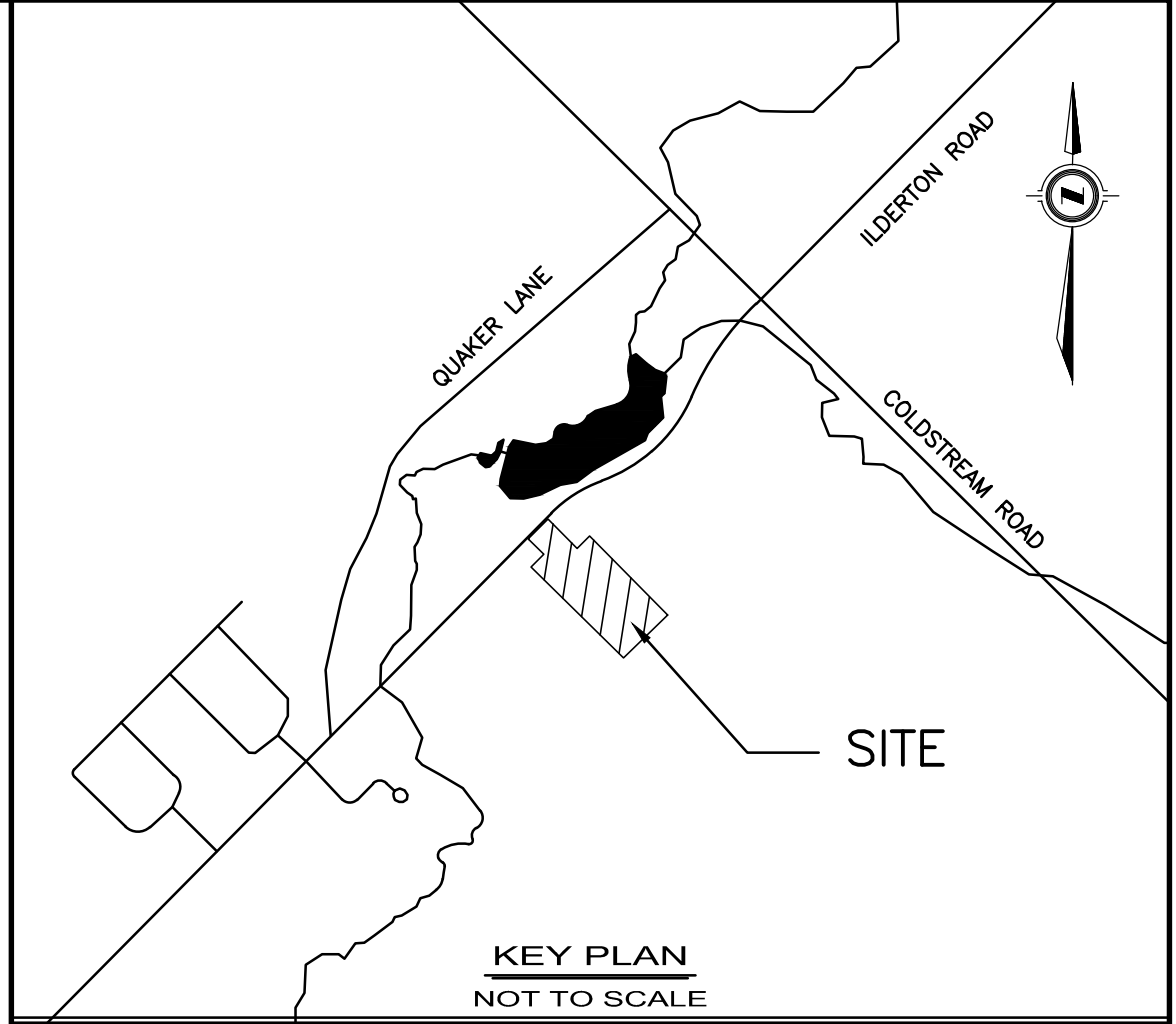

INSTITUTIONAL
(I)

AGRICULTURAL
(A1-25)

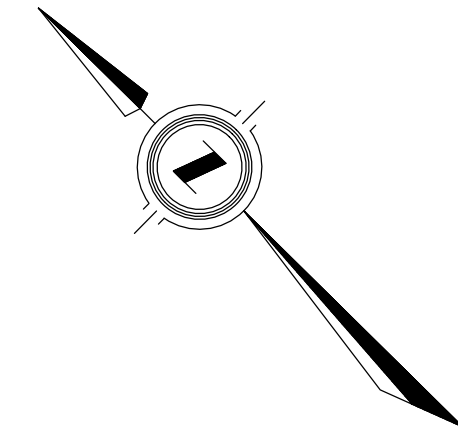

DRAFT PLAN OF SUBDIVISION
 OF PART OF
LOT 7 CONCESSION 8
 (GEOGRAPHIC TOWNSHIP OF LOBO)
 NOW IN THE
MUNICIPALITY OF MIDDLESEX CENTRE
 COUNTY OF MIDDLESEX
 SCALE 1:500

SURVEYOR'S CERTIFICATE:
 I CERTIFY THAT THE BOUNDARIES OF THE LANDS TO BE SUBDIVIDED AS SHOWN ON THIS PLAN AND THEIR RELATIONSHIP TO ADJACENT LANDS ARE ACCURATELY AND CORRECTLY SHOWN.

DATE _____
 ONTARIO LAND SURVEYOR

OWNER'S CERTIFICATE:
 I HEREBY SUBMIT THIS DRAFT PLAN OF SUBDIVISION.
VALLEYVIEW DEVELOPMENTS

DATE _____

I HAVE THE AUTHORITY TO BIND THE CORPORATION

ADDITIONAL INFORMATION REQUIRED UNDER SECTION 51 (17) OF THE PLANNING ACT.

(a) AS SHOWN ON PLAN	(g) AS SHOWN ON PLAN
(b) AS SHOWN ON PLAN	(h) PIPED WATER
(c) AS SHOWN ON KEY PLAN	(i) SANDY
(d) SINGLE FAMILY RESIDENTIAL	(j) AS SHOWN ON PLAN
(e) AS SHOWN ON PLAN	(k) FULL SERVICES
(f) AS SHOWN ON PLAN	(l) NONE

LAND USE SCHEDULE

SINGLE FAMILY RESIDENTIAL LOTS 1 TO 13	2.694 ha.
BLOCK 14 (OPEN SPACE)	0.028 ha.
BLOCK 15 (STORMWATER MANAGEMENT)	0.231 ha.
STREET 'A'	0.624 ha.
TOTAL AREA	3.577 ha.

METRIC:
 DISTANCES SHOWN ON THIS PLAN ARE IN METRES AND CAN BE CONVERTED TO FEET BY DIVIDING BY 0.3048.
 AREAS SHOWN ON THIS PLAN ARE IN HECTARES AND CAN BE CONVERTED TO ACRES BY MULTIPLYING BY 2.471054.

LAND USE SCHEDULE



No.	REVISIONS	DATE	BY
1			

AGM ARCHIBALD, GRAY & MCKAY
 ENGINEERING LTD.
 3514 WHITE OAK ROAD, LONDON, ON, N6E 2Z9
 PHONE 519-685-5300 FAX 519-685-5303
 EMAIL info@agm.on.ca WEB www.agm.on.ca

PLAN • SURVEY • ENGINEER

DRAWN BY: LRG DIGITAL FILE: 1430-1 base.dwg PLAN No:
 CHECKED BY: DTW COGO FILE: _____
 DATE: NOVEMBER 2019 OFFICE FILE: 1430-1 **DP2**